



Victoria Rise, Clapham, SW4

2 bedroom flat - conversion for sale

£650,000

Share of Freehold

Property Details

Set within a grand Victorian townhouse, this elegant two bedroom apartment spans the raised ground floor, boasting soaring ceilings, period charm, and an abundance of natural light. The impressive reception room is a showstopper, featuring a stunning bay window with original wooden shutters, flooding the space with light. Wooden flooring, a decorative fireplace, and bespoke shelving create a stylish yet cosy atmosphere, with ample room for dining and entertaining. The semi open-plan kitchen seamlessly adjoins, blending modern and traditional design with shaker-style cabinetry, wooden worktops, metro tiling, and a butler sink. Both double bedrooms are peacefully positioned at the rear, offering tranquil leafy views. The principal bedroom benefits from fitted wardrobes, while both are neutrally decorated with plush carpeting. A sleek bathroom with a walk-in rain shower and quality fittings completes the home. A welcoming hallway with statement wallpaper and smart storage solutions enhances the first impression, ensuring a practical yet stylish entrance to this charming period property. The exterior of the property has also been recently renovated.

Council tax band D

EPC rating C (75)

Features

- Two double bedrooms
- Victorian conversion
- Boasting grandeur and characterful features
- Bright and airy throughout
- Desirable and enviable location
- Clapham Common at the end of the street
- Amenities of Clapham Old Town
- Northern Line and Overground within walking distance
- Share of freehold
- Chain-free



Victoria Rise, Clapham, SW4

Victoria Rise, SW4
2 Bedroom Flat

APPROXIMATE GROSS INTERNAL AREA: **682 SQ FT / 63.3 SQ M**

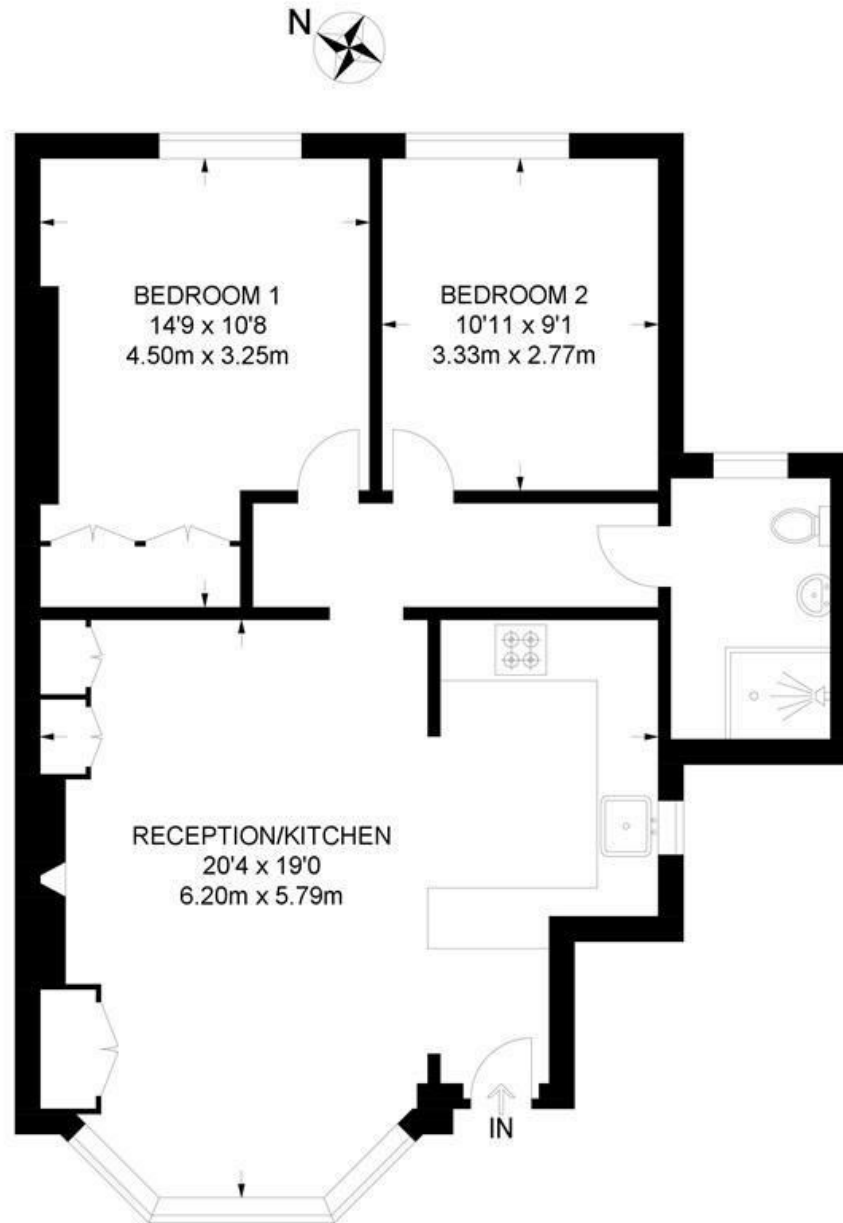

RAISED GROUND FLOOR



While we try our very best, floor plans are produced as a guide only and we take no responsibility for the precise accuracy with which any property is represented.

Victoria Rise, Clapham, SW4

